

W2 CPM

DIRECTIONS FOR USE

W2 FEATURES:

- Full range of motion in flexion/extension, ulnar and radial deviation or a combination of the two.
- Anatomical free-linkage movement with floating hand support which eliminates compression and distraction of radial carpal joint.
- Easy setup and alignment.
- Two operating force settings.
- No reassembly required to change from flexion to deviation.
- Durable, compact and fully portable.
- Lightweight and comfortable.
- Reverse-on-load safety feature.
- Rechargeable battery operation.

SPECIFICATIONS:

Weight of Device: approx. 1.0 kg (2.2 lbs.), including softgoods
 Dimensions of Device: 31.0 x 11.0 x 14.0 cm (12.0 x 4.5 x 5.5)
 Dimensions of Motion Controller: 9.6 x 18.0 x 3.7 cm (3.75 x 7.0 x 1.5)
 Range of Motion:
 Flexion 0° to 90°
 Extension 0° to 90°
 Full Ulnar and Radial Deviation up to 90°
 Rate of Speed: 180° per minute
 Force Settings: Low 2.8 Nm (25 in-lbs.) High 4.0 Nm (35 in-lbs.)
 Power Supply: Input: 100-240Vac 50/60Hz 40VA Output: 12Vdc 1.25A
 Battery Life: up to 100 hours
 Electric Shock Classification: Class 1
 Degree of Electric Shock Protection: Type B
 Environmental Conditions: -10° to 35°C (14° to 95°F) temperature, 90% maximum humidity ATM pressure 750 to 1250 hPa pressure
 Caution: Equipment not suitable for use in the presence of flammable anaesthetic mixture with air or Nitrous Oxide.

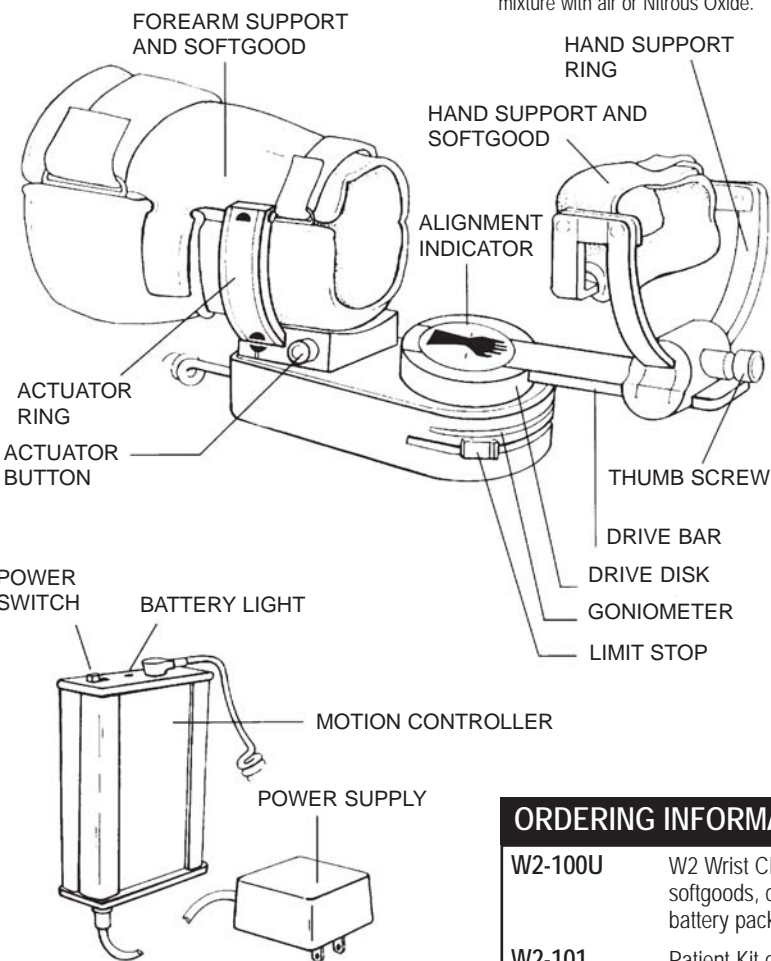

INDICATIONS:

- Distal radius fractures (stable);
- Open Carpal Tunnel Procedures;
- Ganglionectomy;
- Rheumatoid-neurological or after-burn stiffness;
- Synovectomy;
- (RSD) Reflex Sympathetic Dystrophy;
- Following arthrotomy and drainage of acute septic arthritis providing infection is controlled.

CONTRAINDICATIONS:

- Septic tenosynovitis, until infection is controlled;
 - Unstable fractures.
- Note:* If signs of infection such as hyperthermia, irritation, swelling, bleeding, or increased or persistent pain are observed, CPM should be avoided or discontinued until infection is controlled.

ORDERING INFORMATION:

W2-100U	W2 Wrist CPM device, complete with softgoods, carrying case and rechargeable battery pack.
W2-101	Patient Kit complete (disposable)

WARNING:

- Indoor use only. Do not immerse in liquid.
- Do not reuse disposable components.

- Do not store device above 40° C (104° F).
- Service only by a qualified technician.

CAUTION: As with all portable objects, please store the device in a safe location when not in use to avoid a potential tripping hazard.

PLEASE REFER TO ENCLOSED INSERT FOR MAINTENANCE PROCEDURES, CAUTIONS AND WARNINGS, AND WARRANTY INFORMATION.

STEP 1: PREPARING THE DEVICE FOR THE PATIENT

- Install the forearm softgoods by first sliding the large pocket over the forearm support. Fit into place and slide the small pocket over the front end of the forearm support.
- With buckle side down, wrap the hand softgoods around the hand support.
- Plug the device into the Motion Controller.

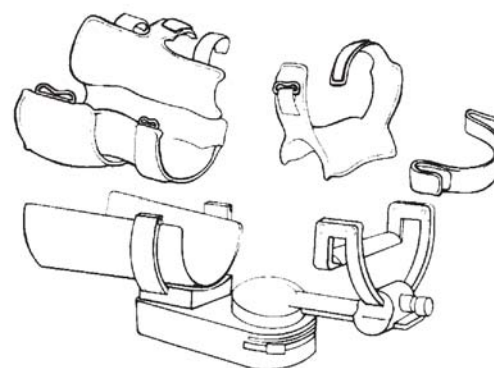

Optional Softgoods:



- The MP Block is fixed to the hand support ring across the digits to maintain MP Flexion throughout the range of motion.
- The sling is used to support the device in portable applications.

STEP 2: SELECTING THE PLANE OF MOTION

Three Setup Options:

1. Single Axis: Flexion/Extension
2. Single Axis: Ulnar/Radial Deviation
3. Combined Axis Motion

Option 1: Flexion/Extension

To position the device for Flexion/Extension:

- Depress the Actuator Button to move the Actuator to align with the Left or Right Hand Flexion graphics at the top side of the Actuator Ring. *Note:* Place the Actuator on the ulnar side of the wrist to avoid possible thumb obstruction.
- Loosen the thumb screw and rotate the hand support ring to the top end. Secure the thumb screw.
- Turn the Motion Controller on and allow the device to move into a 0° position on the goniometer.

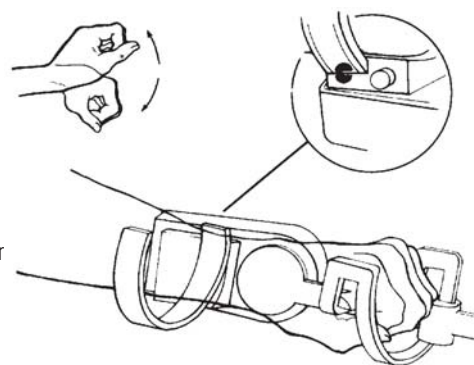

Option 2: Ulnar/Radial Deviation

To position the device for ulnar/radial deviation:

- Depress the Actuator Button to move the Actuator to align with the deviation graphics located on the centre of the Actuator Ring.
- Loosen the thumb screw and rotate the hand support ring to a horizontal position. Secure the thumb screw.
- Turn the Motion Controller on and allow the device to move into a 0° position on the goniometer.

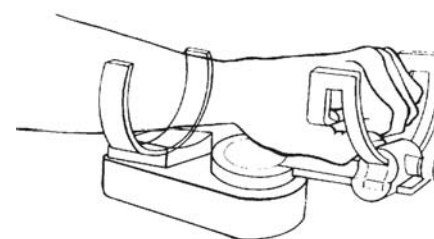

Option 3: Combined Axes Motion

To position the device for combined axes motion:

- Depress the Actuator Button to position the Actuator at any of the stop points along the Actuator Ring.
- Loosen the thumb screw and rotate the hand support ring to a horizontal position. Secure the thumb screw.
- Turn the Motion Controller on and allow the device to move into a 0° position on the goniometer.

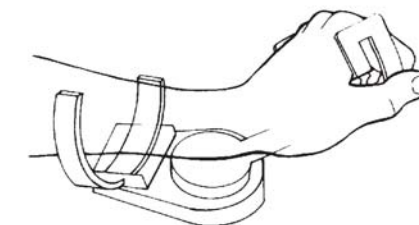

STEP 3: DEVICE APPLICATION AND ALIGNMENT

Note: The Wrist Alignment indicator is located on the Drive Disk.

- Open the hand and forearm softgoods. Slide the Hand Support to the end of the drive bar.
- Place the forearm in the Forearm Support, and align the centre of the wrist with the Alignment Indicator.
- Slide the Hand support into the palm of the patient's hand.
- Secure the softgoods.

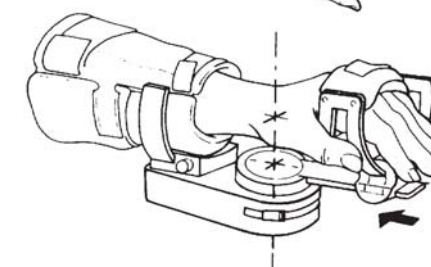
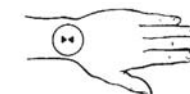

STEP 4: SETTING RANGE OF MOTION

To set the range of motion in any of the three Plane of Motion options:

Depress and rotate the limit stops to the prescribed range of motion on the goniometer.

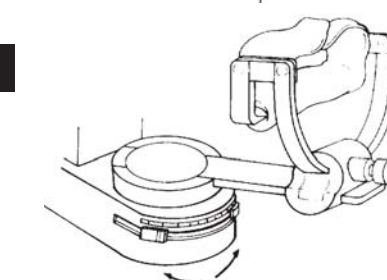

STEP 5: INITIATE TREATMENT

The Motion Controller is equipped with two Operating Force Settings as indicated by the large and small graphics at the Power Switch. (Small graphic indicates low force setting, large graphic indicates high force setting.)

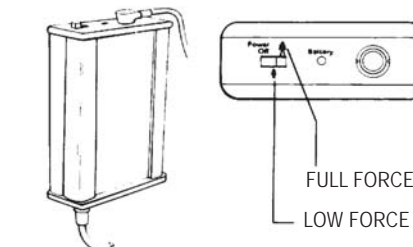

RANGE OF MOTION OPTIONS

Dynamic Traction Mode:

To use the W2 in a dynamic traction mode:

- Place the Limit Stops just outside the patient's range.

- Select the LOW force setting on the Motion Controller.

CAUTION: This feature should only be used as prescribed by the physician or therapist.

SYMBOLS

	Power Off		Deviation		Type B Applied Part
	Power On		Danger Electric Shock: Service by qualified individual only		Class II Equipment
	High Load Setting		Attention, Consult ACCOMPANYING DOCUMENTS		Use specified power supply only
	Low Load Setting		Danger Explosive Risk: If used with flammable anaesthetic		This Way Up
	Right Hand Flexion		Caution: FDA Policy. Federal U.S. Law restricts this device to sale by or on the order of a licensed healthcare practitioner.		Fragile
	Left Hand Flexion		Keep Dry		

Otto Bock®

QUALITY FOR LIFE



ORTHOREHAB
 901 Dillingham Road, Pickering, Ontario L1W 2Y5 Canada
 Intl. Tel: 1-905-420-3303 Fax: 1-905-420-3970

EC REP RSQR Ltd. Ludgate House, 107-111
 Fleet Street, London EC4A 2AB
 info@rsqa.co.uk www.rsqa.co.uk



ORTHOREHAB is registered to ISO13485 for Quality Assurance